

SEFA Presentations at ARABLAB 2022

Innovative Labs Throughout the World — Fitchburg, Wisconsin, USA

The Scientific Equipment & Furniture Association (SEFA) is featuring a series of presentations focused on innovative lab projects from throughout the world. These presentations will take place inside the SEFA Theatre within the trade show area. Join SEFA, SmithGroup and Fundermax on Tuesday morning, October 25, 2022 at 14:00 for another stop on SEFA's tour of Innovative Labs Throughout the World —

Kornberg Center—Promega Corporation Fitchburg, Wisconsin

“Kornberg Center is a catalyst to innovation. Along with the advanced technology, the building design itself inspires inventive thinking, fueling us to imagine the unimagined. If your workplace looks like everywhere else, you will end up thinking like everyone else.” - Poncho Meisenheimer, Vice President, R&D, Promega

Promega Corporation is an international biotechnology company serving life science research and applications with values in long term planning, creative thinking, attention to detail, flexibility and transformational development. Named for the Nobel Prize-winning biochemist Arthur Kornberg, the 280,000-square foot Kornberg Center research and development facility advances research capacity and capability in creating tools and technologies that support most novel methods and techniques in research, drug development, forensic science, clinical and molecular diagnostics and applied testing. Nestled into a clearing and surrounded by woodlands, the design takes inspiration from nature, scientific workflow and a people-centric business approach that facilitates leading-edge scientific discovery.

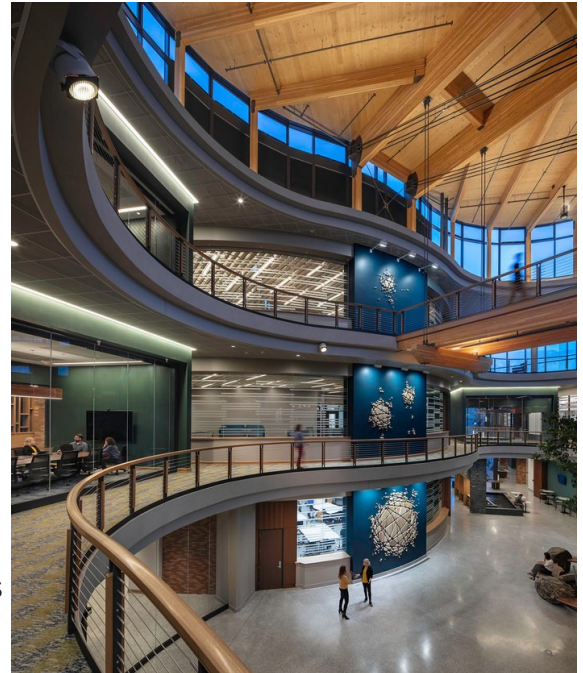

Promega's culture embraces the principles of well-being and emotional and social intelligence to help employees flourish by improving relationships, managing stress and enhancing connections.

About the Speaker

Diane Kase, RID, LEED AP - Diane is a strategic, analytical, resourceful laboratory planner, designer, project coordinator and project manager with exceptional attention to detail. She has over 32 years experience with a concentration in laboratory projects for academic instruction and research, as well as institutional, biotechnological and pharmaceutical research. Diane is recognized for a unique ability of knowing the questions to ask all stakeholders and ability to obtain that information from them to insure project success. Diane is viewed as a subject matter expert and trusted advisor by her colleagues and clients. Mentor to junior staff and go-to person for peers and upper management for direction on a range of topics, particularly project details and considerations often overlooked by others. Demonstrated ability to design, coordinate and problem solve on complex projects working remotely and with geographically dispersed clients and cross-functional teams including: engineers, architects, specialty consultants, landscape architects, government officials, building owners, and co-workers. Continuously demonstrates dedication and commitment to clients and ability to problem solve and provide quick and thorough responses to project needs and requests.